

### Small EPDM Rubber T-Handle Latch UV

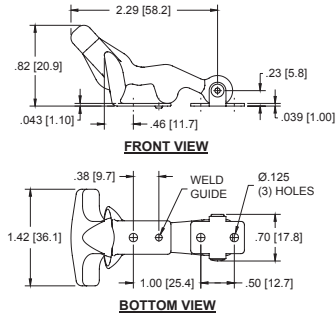

long keeper



Part Number	Keeper Style	Keeper Material	Keeper Finish
220-100SS	long	304SS	passivated
220-100ZN	long	steel	zinc plated

▶ dimensions shown are after installation

### Medium EPDM Rubber T-Handle Latches UV



Part Number	Keeper Style	Description	Keeper Material	Keeper Finish
220-200SS	long	fixed assembled (riveted)	304SS	passivated
<b>NEW</b> 220-200ZN	long	fixed assembled (riveted)	steel	zinc plated
<b>NEW</b> 220-200SS50	long	unassembled (cotter pin)	304SS	passivated
<b>NEW</b> 220-200ZN50	long	unassembled (cotter pin)	steel	zinc plated
220-250SS	short	fixed assembled (riveted)	304SS	passivated
<b>NEW</b> 220-250ZN	short	fixed assembled (riveted)	steel	zinc plated
<b>NEW</b> 220-250SS50	short	unassembled (cotter pin)	304SS	passivated
<b>NEW</b> 220-250ZN50	short	unassembled (cotter pin)	steel	zinc plated
<b>NEW</b> 230-2T	---	t-handle only	---	---

▶ dimensions shown are after installation

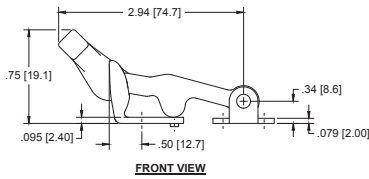

FRONT VIEW

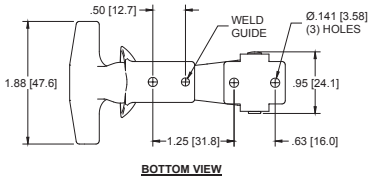

BOTTOM VIEW

LATCH WITH LONG KEEPER

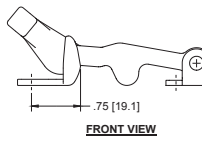

FRONT VIEW

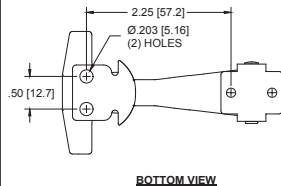

BOTTOM VIEW

LATCH WITH SHORT KEEPER

### Large EPDM Rubber T-Handle Latches UV



fixed assembled (riveted)

unassembled (cotter pin)

short keeper

Part Number	Keeper Style	Description	Keeper Material	Keeper Finish
220-300SS	long	fixed assembled (riveted)	304SS	passivated
<b>NEW</b> 220-300ZN	long	fixed assembled (riveted)	steel	zinc plated
<b>NEW</b> 220-300SS50	long	unassembled (cotter pin)	304SS	passivated
<b>NEW</b> 220-300ZN50	long	unassembled (cotter pin)	steel	zinc plated
220-350SS	short	fixed assembled (riveted)	304SS	passivated
<b>NEW</b> 220-350ZN	short	fixed assembled (riveted)	steel	zinc plated
<b>NEW</b> 220-350SS50	short	unassembled (cotter pin)	304SS	passivated
<b>NEW</b> 220-350ZN50	short	unassembled (cotter pin)	steel	zinc plated
<b>NEW</b> 230-3T	---	t-handle only	---	---

▶ dimensions shown are after installation

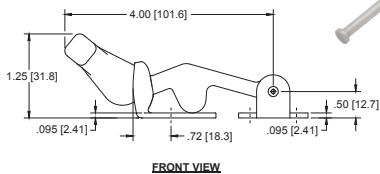

FRONT VIEW

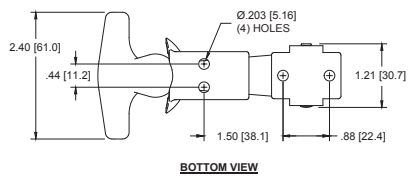

BOTTOM VIEW

LATCH WITH LONG KEEPER

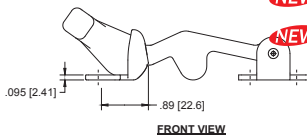

FRONT VIEW

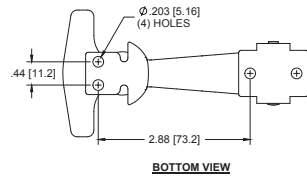

BOTTOM VIEW

LATCH WITH SHORT KEEPER