

Stainless Steel Marine Specialty Hinges

SCALE 1:2

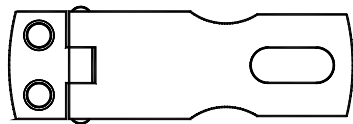

M0827

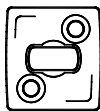

M0627
316SS material

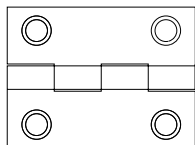
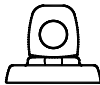
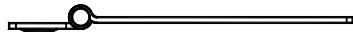

M0990

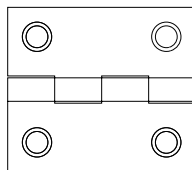

M0991

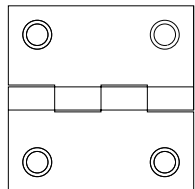

M0992

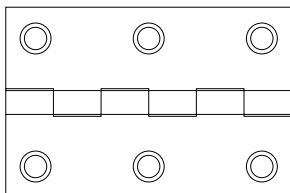

M0993

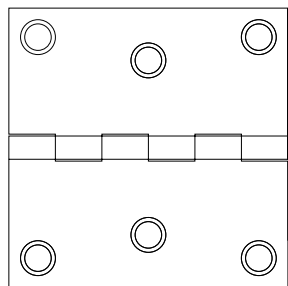

M0994

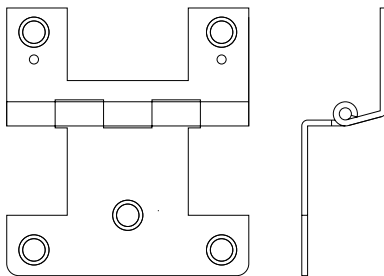

M0995
special order only

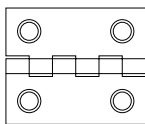

M0996
.035" thick with a Ø.091 pin

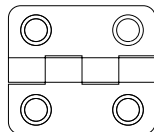

M0997

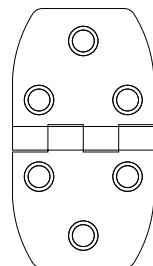

M0998

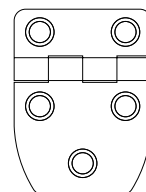

M0999

Part Number	Length	Open Width	Number of Holes	Holes Size
M0627	1.08	1.17	2	#8
M0827	1.13	3.60	2	#7
M0990	2.00	1.50	4	#8
M0991	2.00	1.75	4	#8
M0992	2.00	2.00	4	#8
M0993	3.00	2.00	6	#8
M0994	3.00	3.00	6	#10
M0995	2.50	2.76	5	#8
M0996	1.50	1.25	4	#5
M0997	1.50	1.31	4	#8
M0998	1.50	2.75	6	#8
M0999	1.50	2.03	5	#8
M1000	1.50	4.00	4	#8
M1001	1.50	6.00	6	#8
M1002	2.00	2.50	4	#8
M1003	2.00	2.75	4	#8
M1004	1.50	2.65	4	#8
M1005	1.50	2.03	5	#8
M1008	1.50	1.31	4	#8
M1009	1.50	1.31	4	#8
M1010	2.13	4.24	5	#8
M1012	1.06	4.00	4	#8
M1067	2.00	3.00	4	#9
M7203	3.44	1.19	4	#8

- ▶ tough, durable, rugged T302/304SS leaves and pin
- ▶ deep countersunk holes for heavy duty fastening strength
- ▶ electropolished to a high luster and passivated for superior corrosion resistance.
- ▶ all hinges shown on these pages are .060" thick, with Ø.120" pin, except where otherwise indicated