

9mm Straight and Offset Cams

Front View

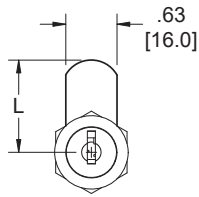

Straight Cam

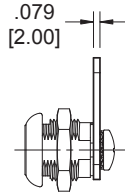

Offset In Cam

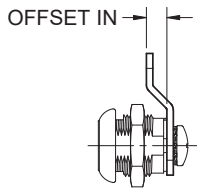

Offset Out Cam

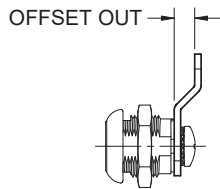

Dimension L	Straight	Offset Dimensions				
		.063 [1.60]	.125 [3.18]	.188 [4.76]	.250 [6.35]	.375 [9.53]
.563 [14.30]	KC100	---	---	---	---	---
.625 [15.88]	KC101	---	---	---	---	---
.688 [17.48]	KC102	---	---	---	---	---
.750 [19.05]	KC103*	---	---	---	---	---
.813 [20.65]	KC104	---	---	---	---	---
.875 [22.23]	KC105*	KC404	KC429	KC454	KC479*	---
.938 [23.83]	KC106	KC405*	KC430	KC455	KC480	---
1.000 [25.40]	KC107*	KC406	KC431	KC456*	KC481*	---
1.063 [27.00]	KC108	KC407	KC432	KC457	KC482	KC147
1.125 [28.58]	KC109*	KC408	KC433	KC458	KC483	KC148
1.188 [30.18]	KC110*	KC409	KC434	KC459*	KC484	KC149
1.250 [31.75]	KC111*	KC410*	KC435*	KC460*	KC485*	KC150*
1.313 [33.35]	KC112	KC411	KC436	KC461	KC486	KC151
1.375 [34.93]	KC113	KC412	KC437	KC462	KC487	KC152*
1.438 [36.53]	KC114	KC413	KC438	KC463	KC488	KC153
1.500 [38.10]	KC115*	KC414*	KC439*	KC464*	KC489*	KC154*
1.563 [39.70]	KC116	KC415	KC440	KC465*	KC490	KC155
1.625 [41.28]	KC117	KC416	KC441	KC466	KC491	KC156
1.688 [42.88]	KC118	KC417	KC442	KC467	KC492	KC157
1.750 [44.45]	KC119*	KC418*	KC443*	KC468*	KC493*	KC158*
1.813 [46.05]	KC120	KC419	KC444	KC469	KC494	KC159
1.875 [47.63]	KC121	KC420	KC445	KC470	KC495	KC160
1.938 [49.23]	KC122	KC421	KC446	KC471	KC496	KC161
2.000 [50.80]	KC123*	KC422*	KC447*	KC472*	KC497*	KC162*
2.063 [52.40]	KC124*	---	---	---	---	---
2.125 [53.98]	KC125	---	---	---	---	---
2.188 [55.58]	KC126	---	---	---	---	---
2.250 [57.15]	KC127*	---	---	---	---	---
2.313 [58.75]	KC128	---	---	---	---	---
2.375 [60.33]	KC129	---	---	---	---	---
2.438 [61.93]	KC130	---	---	---	---	---
2.500 [63.50]	KC131*	---	---	---	---	---

▶ steel, zinc plated
▶ may have a square or star punch

▶ * these cams are stock items

Miscellaneous Cams

Part Number	Material	Finish
KC010*	steel	zinc plated



Offset Cam

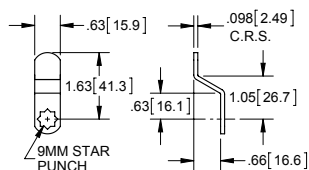

Part Number	Material	Finish
KC030	steel	zinc plated



Bent Cam

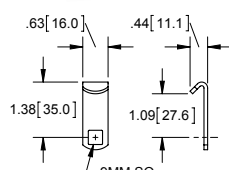

Part Number	Material	Finish
KC900	steel	zinc plated



Bent Cam

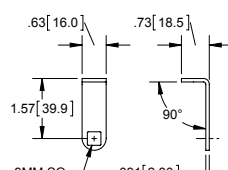

Part Number	Material	Finish
KC006*	.118 [3] steel	zinc plated



Hook Cam Straight

