

Spring Loaded Wire Door Holders

Part No.	Length	Material	Finish
60101*	4 [102]	steel	zinc plated
601SS01	4 [102]	304SS	electropolished
603SS01	4 [102]	304SS includes female receiver with stop feature	electropolished
603SS02	6 [152]	304SS includes female receiver with stop feature	electropolished

- ▶ parts include female receiver
- ▶ female receiver with stop feature may be purchased separately as part no. **603SS03**; see pg. 338 for close-up
- ▶ spring loaded bail to prevent rattle
- ▶ * non-stock

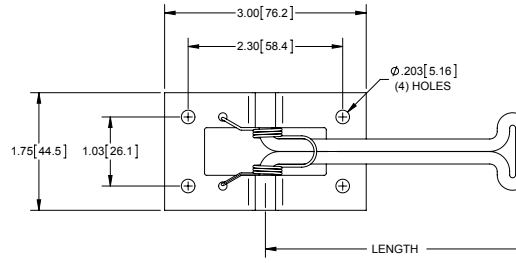

female dimensions are the same as male overall dimensions.

Spring Loaded 45° Wire Door Holders

Part Number	Length	Material	Finish	Description
60202SS01	4 [102]	304SS	electropolished	right hand holder
NEW 60202SS05	4 [102]	304SS	electropolished	left hand holder

- ▶ part includes female receiver
- ▶ spring loaded bail to prevent rattle

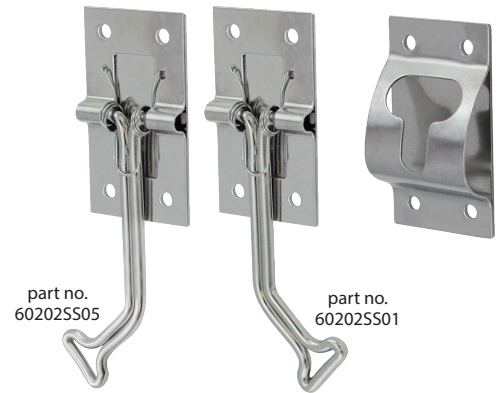
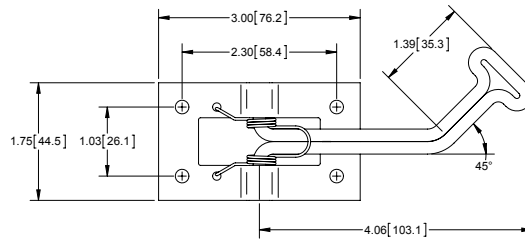

female dimensions are the same as male overall dimensions.

Spring Loaded 90° Wire Door Holders

Part Number	Length	Material	Finish
60201*	2 [51]	steel	zinc plated
602SS01	2 [51]	304SS	electropolished

- ▶ parts include female receiver
- ▶ spring loaded bail to prevent rattle
- ▶ * non-stock

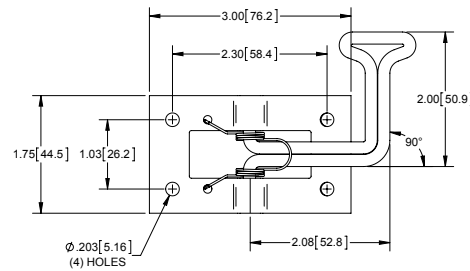

female dimensions are the same as male overall dimensions.

Baggage Door Catch

Part Number	Description	Finish
625	die cast zinc pull	silver paint
	18 gauge 304SS base	mill

- ▶ spring loaded (stainless steel spring)

